



## Instructions on how to use Nevolat 6 mg/ml solution for injection in pre-filled pen

Please read these instructions carefully before using your Nevolat pre-filled pen.

**Do not use the pen without proper training** from your doctor or nurse. Start by checking your pen to **make sure that it contains Nevolat (liraglutide 6 mg/ml)**, then look at the illustrations below to get to know the different parts of your pen and needle.

**If you are blind or have poor eyesight and cannot read the dose counter on the pen, do not use this pen without help.** Get help from a person with good eyesight who is trained to use the Nevolat pre-filled pen.

Your pen is a pre-filled dial-a-dose pen. It contains 18 mg of liraglutide and delivers doses of 0.6 mg, 1.2 mg, 1.8 mg, 2.4 mg and 3.0 mg. Needles are not included in the pack. BD Ultra fine™ or NovoFine® disposable needles are recommended for use with this device.

### Important information

Pay special attention to these notes as they are important for safe use of the pen.

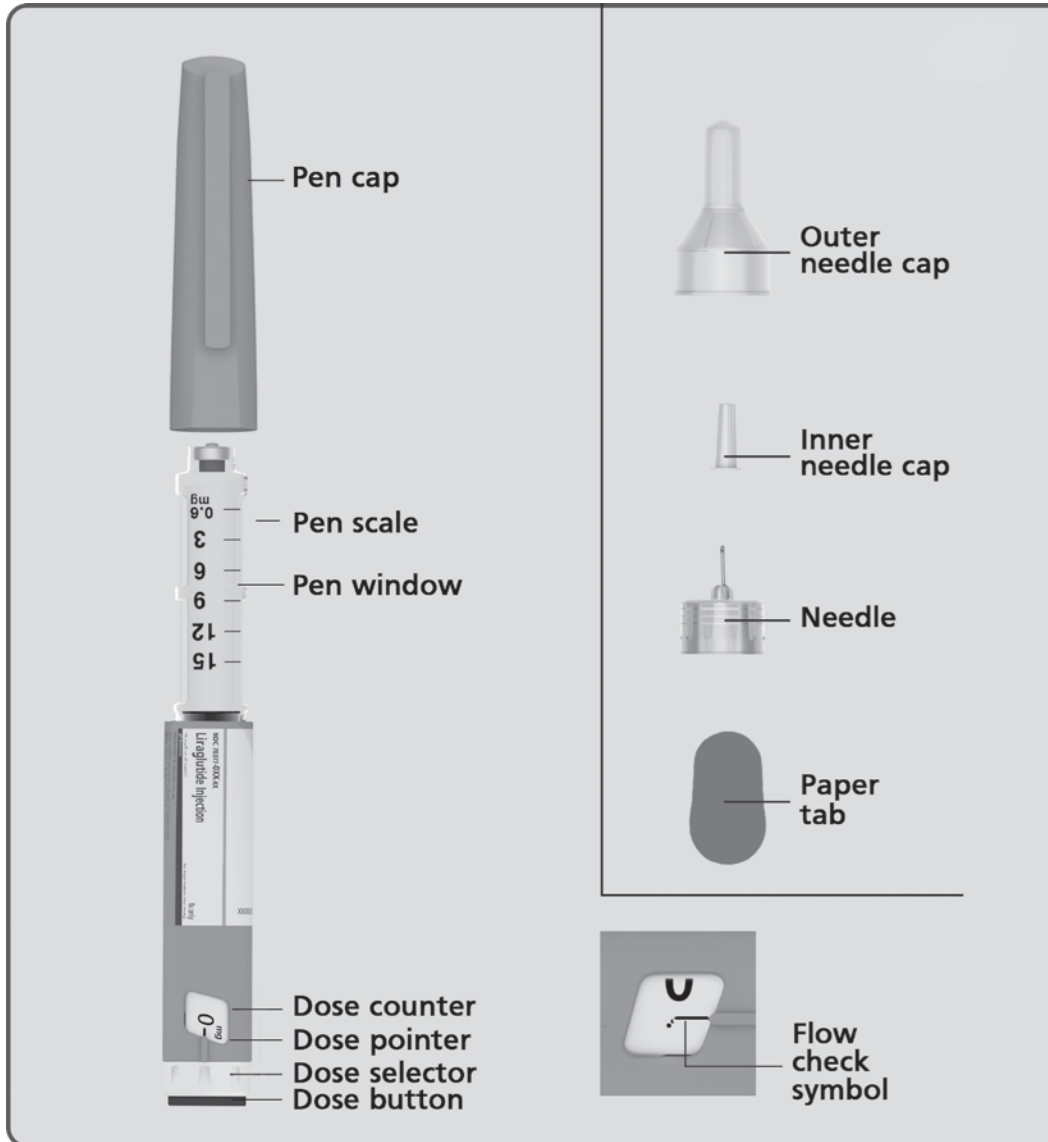

### 1 Prepare your pen with a new needle

• **Check the name and coloured label** of your pen, to make sure that it contains Nevolat. This is especially important if you take more than one type of injectable medicine. Using the wrong medicine could be harmful to your health.

• **Pull off the pen cap.**

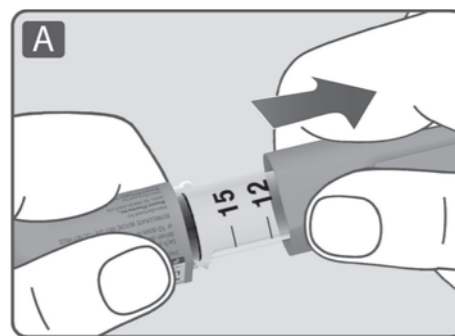

• **Check that the solution in your pen is clear and colourless.** Look through the pen window. If the solution looks cloudy, do not use the pen.

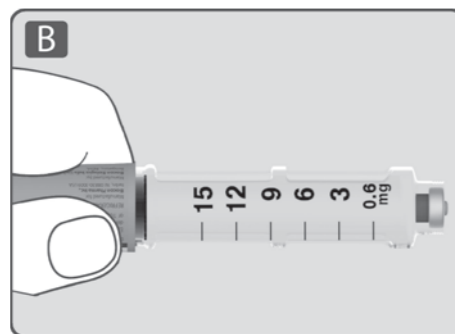

• **Take a new needle** and tear off the paper tab.

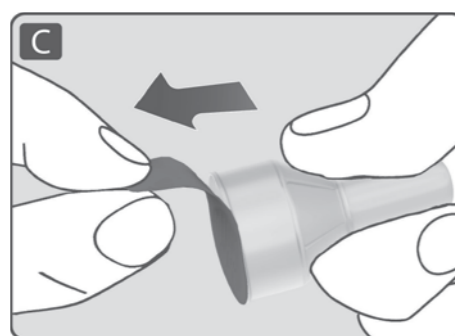

**Make sure to attach the needle correctly.** Push the needle straight onto the pen. Turn until it is on tight.

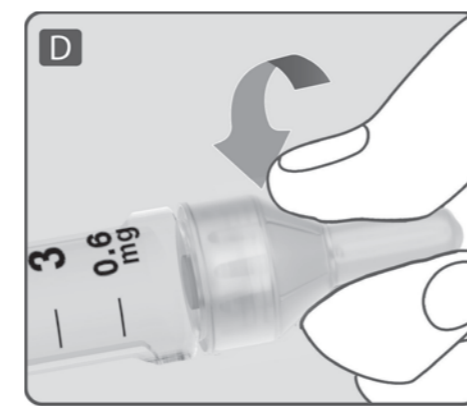

**The needle is covered by two caps. You must remove both caps. If you forget to remove both caps you will not inject any solution.**

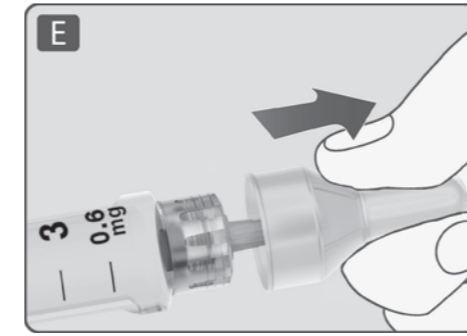

**Pull off the outer needle cap and keep it for later.** You will need it after the injection, to safely remove the needle from the pen.

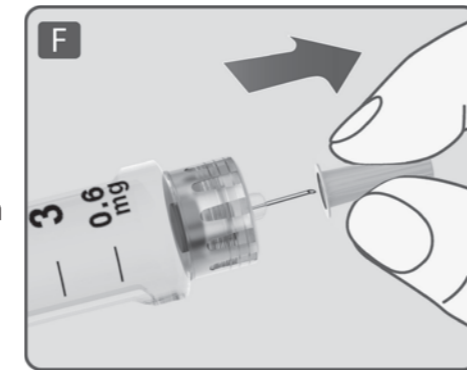

**Pull off the inner needle cap and throw it away.** If you try to put it back on, you may accidentally stick yourself with the needle.

A drop of solution may appear at the needle tip. This is normal, but you must still check the flow if you use a new pen for the first time.

**Do not attach a new needle to your pen until you are ready to take your injection.**

△ **Always use a new needle for each injection.**

This may prevent blocked needles, contamination, infection and inaccurate dosing.

△ **Never use a bent or damaged needle.**

### 2 Check the flow

• **Before your first injection with each new pen, check the flow.** If your pen is already in use, go to step 3 'Select your dose'.

• Turn the dose selector until the dose counter shows the flow check symbol (•) right past 0.

• Hold the pen with the needle pointing up.

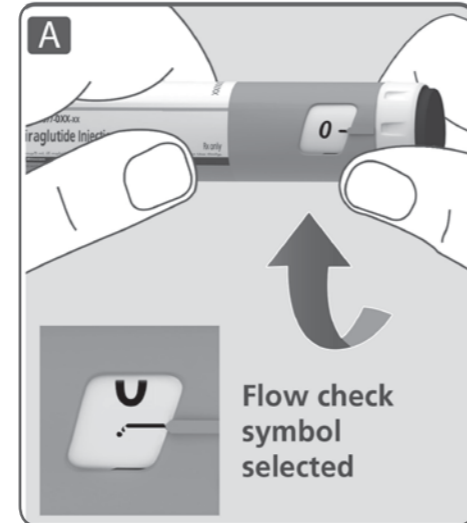

**Press and hold in the dose button** until the dose counter returns to 0. The 0 must line up with the dose pointer. A drop of solution should appear at the needle tip, but it will not be injected.

**If no drop appears,** repeat step 2 'Check the flow' up to 6 times. If there is still no drop, change the needle and repeat step 2 'Check the flow' with each new pen once more.

**If a drop still does not appear,** dispose of the pen and use a new one.

△ **Always make sure that a drop appears** at the needle tip before you use a new pen for the first time. This makes sure that the solution flows. If no drop appears, you will not inject any medicine, even though the dose counter may move. **This may indicate a blocked or damaged needle.**

If you do not check the flow before your first injection with each new pen, you may not get the prescribed dose and the intended effect of Nevolat.

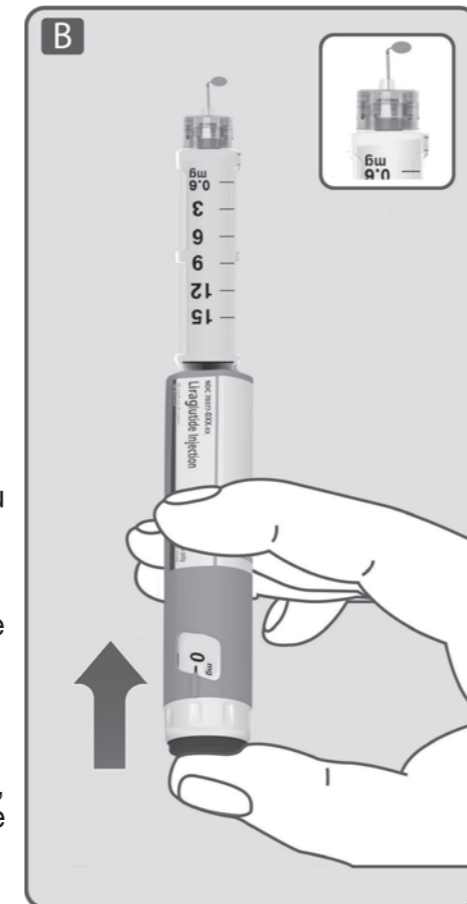

**3 Select your dose**

• Turn the dose selector until the dose counter shows your dose (0.6 mg, 1.2 mg, 1.8 mg, 2.4 mg or 3.0 mg).

If you select the wrong dose, you can turn the dose selector forward or backwards to the correct dose.

The pen can dial up to a maximum of 3.0 mg.

The dose selector changes the dose. Only the dose counter and dose pointer will show how many mg you select per dose.

You can select up to 3.0 mg per dose. When your pen contains less than 3.0 mg the dose counter stops before 3.0 is shown.

The dose selector clicks differently when turned forward, backwards or past the number of mg left. Do not count the pen clicks.

△ **Always use the dose counter and the dose pointer to see how many mg you have selected before injecting this medicine. Do not count the pen clicks. Do not use the pen scale. It only shows approximately how much solution is left in your pen.**

**Only doses of 0.6 mg, 1.2 mg, 1.8 mg, 2.4 mg or 3.0 mg must be selected with the dose selector.**

The selected dose must line up precisely with the dose pointer to ensure that you get a correct dose.

### How much solution is left?

• The pen scale shows you approximately how much solution is left in your pen.

• To see precisely how much solution is left, use the dose counter:

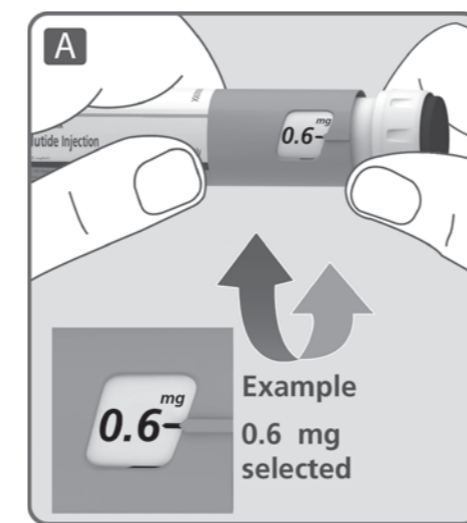

Turn the dose selector until the dose counter stops.

If it shows 3.0, at least 3.0 mg are left in your pen. If the dose counter stops before 3.0 mg, there is not enough solution left for a full dose of 3.0 mg.

**If you need more medicine than what is left in your pen**

Only if trained or advised by your doctor or nurse, you may split your dose between your current pen and a new pen. Use a calculator to plan the doses as instructed by your doctor or nurse.

△ **Be very careful to calculate correctly.**

If you are not sure how to split your dose using two pens, then select and inject the dose you need with a new pen.

### 4 Inject your dose

• **Insert the needle into your skin** as your doctor or nurse has shown you.

• **Make sure you can see the dose counter.** Do not cover it with your fingers. This could interrupt the injection.

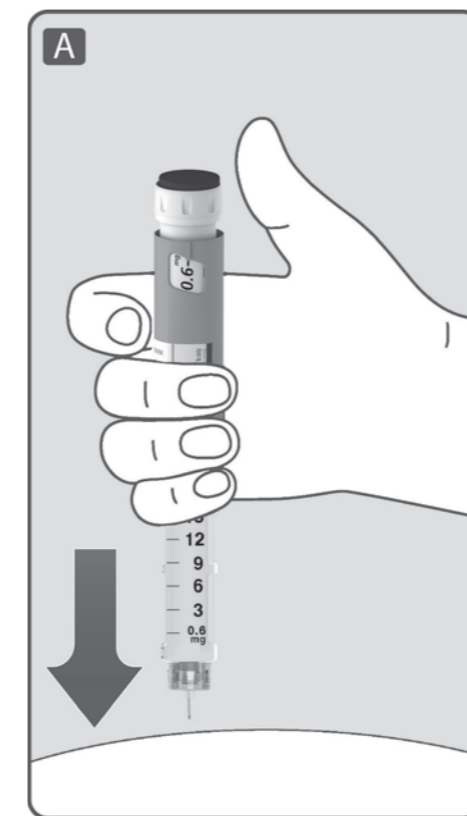
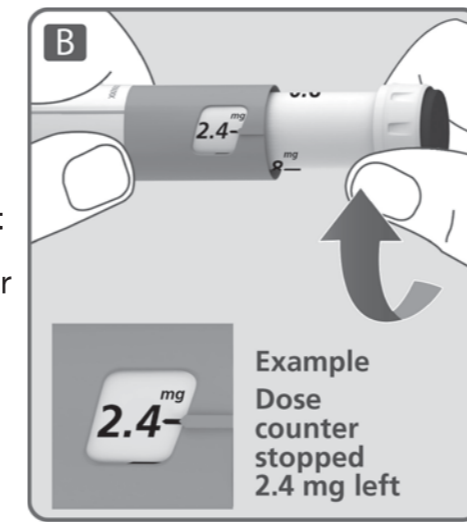
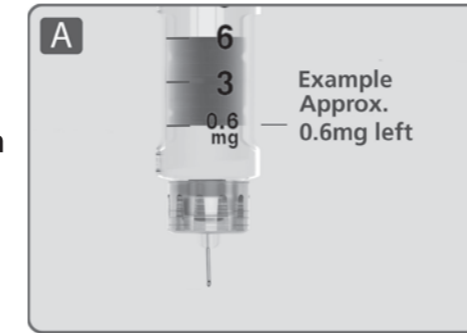

**Press and hold down the dose button until the dose counter shows 0.** The 0 must line up with the dose pointer. You may then hear or feel a click.

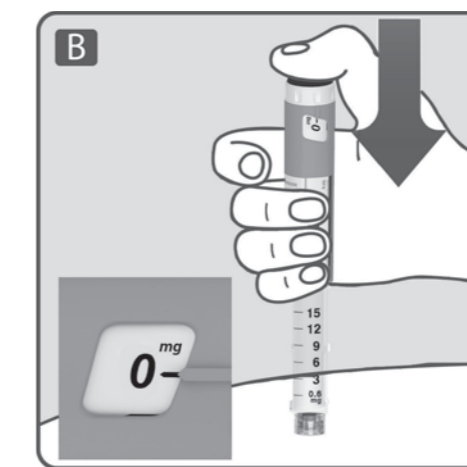

**Keep the needle in your skin after the dose counter has returned to 0 and count slowly to 6.**

If the needle is removed earlier, you may see a stream of solution coming from the needle tip. If so, the full dose will not be delivered.

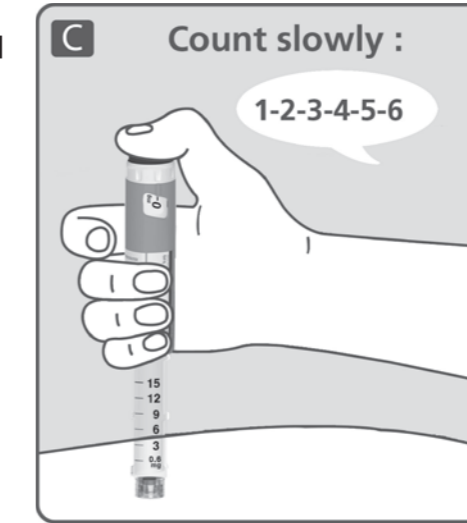

**Remove the needle from your skin. You can then release the dose button.**

If blood appears at the injection site, press lightly. Do not rub the area. You may see a drop of solution at the needle tip after injecting. This is normal and does not affect your dose.

△ **Always watch the dose counter to know how many mg you inject.** Hold the dose button down until the dose counter shows 0.

**How to identify a blocked or damaged needle?**

• If 0 does not appear in the dose counter after continuously pressing the dose button, you may have used a blocked or damaged needle.

• In this case – you have not received any medicine – even though the dose counter has moved from the original dose that you have set.

**How to handle a blocked needle?**

Change the needle as described in step 5 'After your injection' and repeat all steps starting with step 1 'Prepare your pen with a new needle'. Make sure you select the full dose you need.

**Never touch the dose counter when you inject.** This can interrupt the injection.

### 5 After your injection

**Lead the needle tip into the outer needle cap on a flat surface** without touching the needle or the outer needle cap.

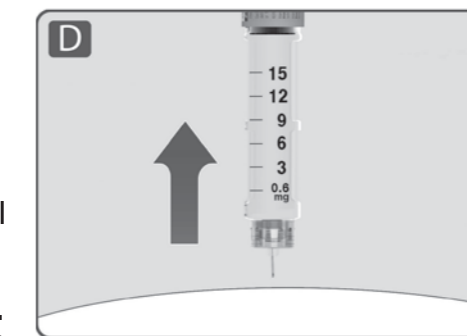

• Once the needle is covered, **carefully push the outer needle cap completely on.**

• **Unscrew the needle** and dispose of it carefully.

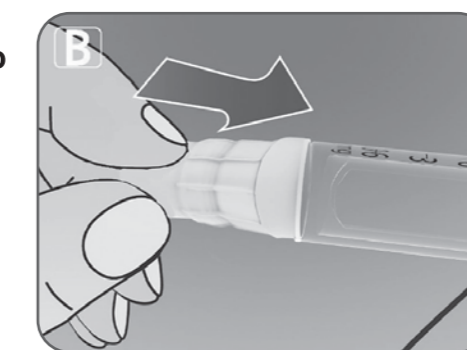
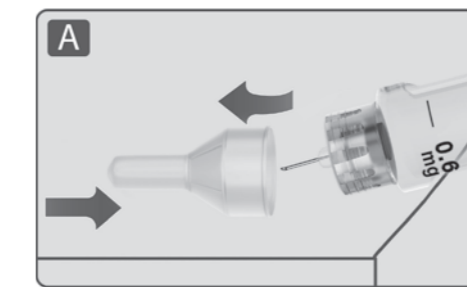

• **Put the pen cap on your pen** after each use to protect the solution from light.

**Always dispose the needle after each injection** to ensure convenient injections and prevent blocked needles. If the needle is blocked, you will not inject any medicine. When the pen is empty, throw it away **without a needle on** as instructed by your doctor, nurse, pharmacist or local authorities.

△ **Never try to put the inner needle cap back on the needle.** You may stick yourself with the needle.

△ **Always remove the needle from your pen after each injection.**

This may prevent blocked needles, contamination, infection, leakage of solution and inaccurate dosing.

△ **Further important information**

• Always keep your pen and needles **out of sight and reach of others**, especially children.

• **Never share your pen or your needles** with other people.

• Caregivers must be **very careful when handling used needles** - to prevent needle injury and cross-infection.

### Caring for your pen

• **Do not leave the pen in a car** or other place where it can get too hot or too cold.

• **Do not inject Nevolat Injection which has been frozen.** If you do that, you may not get the intended effect of this medicine.

• **Do not expose your pen to dust, dirt or liquid.**

• **Do not wash, soak or lubricate your pen.** If necessary, clean it with a mild detergent on a moistened cloth.

• **Do not drop your pen** or knock it against hard surfaces. If you drop it or suspect a problem, attach a new needle and check the flow before you inject.

• **Do not try to refill your pen.** Once empty, it must be disposed of.

• **Do not try to repair your pen** or pull it apart.

Last updated April 2024.



BFO0618/01

KR/DRUGS/KTK/28/0456/2019

ZENTIVA

1065041201