The following information is intended for medical or healthcare professionals only:

INSTRUCTIONS FOR HEALTH CARE PROFESSIONALS

Any unused medicinal product or waste material should be disposed of in accordance with local requirements.

Abilify Maintena 720 mg prolonged-release suspension for injection in pre-filled syringe
Abilify Maintena 960 mg prolonged-release suspension for injection in pre-filled syringe
aripiprazole

- To be administered by a healthcare professional once every 2 months. Read complete instructions prior to use.
- The suspension for injection is for single use only.
- **For intramuscular use. Gluteal injection only. Do not** administer by any other route.
- Prior to administration, visually inspect the syringe for particulate matter and discoloration.
- The suspension should appear to be a uniform, homogeneous suspension that is opaque and milky-white in colour. Do not use Abilify Maintena if it is discoloured, or particulate matter is present.

Contents of kit

Confirm that components listed below are provided:

- One pre-filled syringe containing either Abilify Maintena 960 mg or 720 mg prolonged-release injectable suspension and two safety needles.
- One sterile 38 mm (1.5 inch) 22 gauge needle with black needle hub.
- One sterile 51 mm (2 inch) 21 gauge needle with green needle hub.

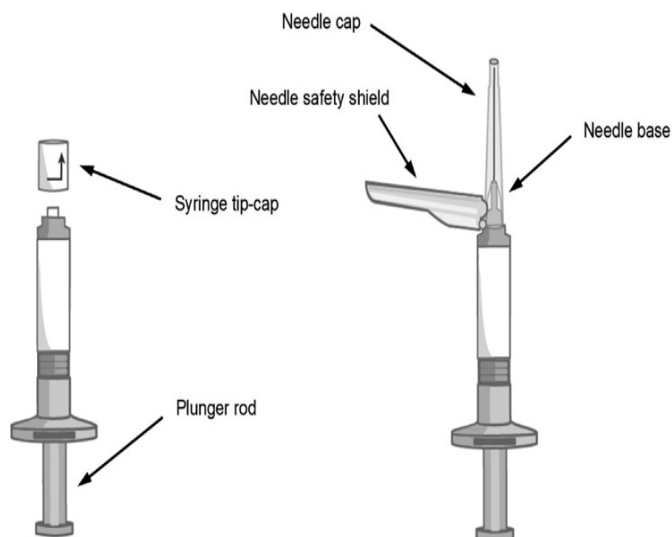

Prepare for injection

- Remove the syringe from the package.
- Tap the syringe on your hand at least 10 times.
- After tapping, shake the syringe vigorously for at least 10 seconds.

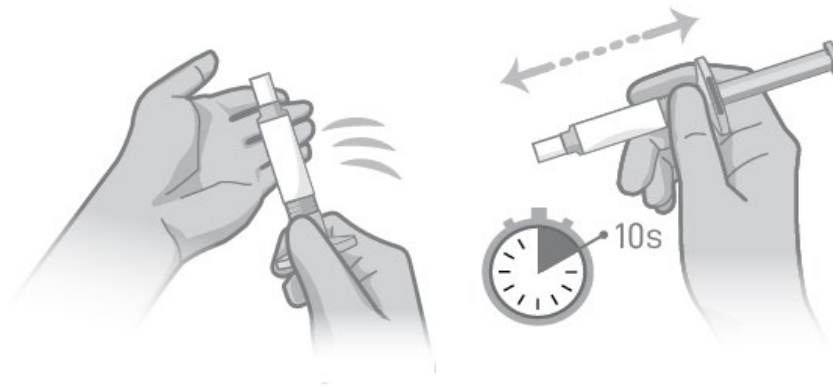

Select the appropriate needle

For gluteal intramuscular administration only.

Needle selection is determined by patient body type.

Body type	Needle size	Needle shield colour
Non-obese (BMI < 28 kg/m ²)	38 mm, 22 gauge	Black
Obese (BMI > 28 kg/m ²)	51 mm, 21 gauge	Green

Attach the needle

- Twist and pull off the pre-filled syringe tip-cap.
- While holding the base of the needle, ensure the needle is firmly seated on the safety device with a push and gently twist clockwise until SECURELY fitted.

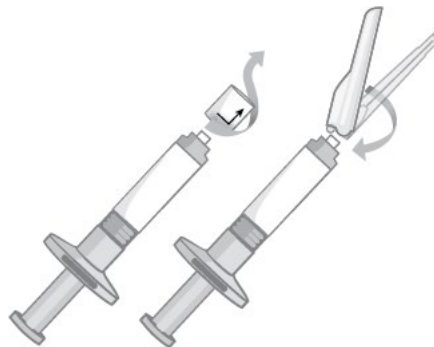

Expel air

- When you are ready to administer the injection, hold the syringe upright and remove the needle cap by pulling straight up. **Do not** twist the needle cap as this may loosen the needle from the syringe.

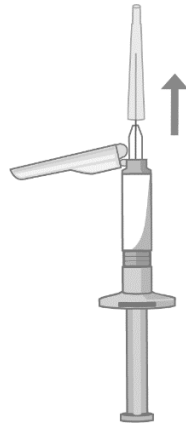

- Slowly advance the plunger rod upward to expel the air and until the suspension fills the needle base.
- Inject immediately after expelling air from syringe.



Inject the dose

- Slowly inject the entire contents intramuscularly into the gluteal muscle of the patient. **Do not administer by any other route.**
- Do not massage the injection site.

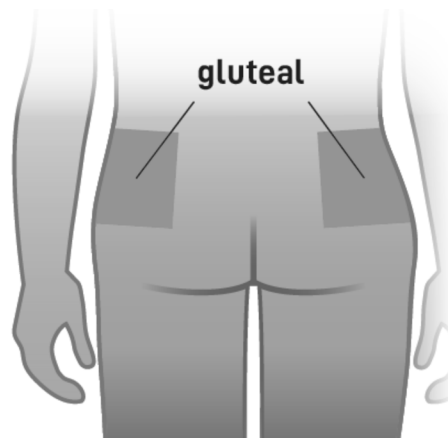

- Remember to rotate sites of injections between the two gluteal muscles.
- If initiating with the two injection start, inject into two different gluteal muscle. **DO NOT** inject both injections concomitantly into the same gluteal muscle.
- Look for signs or symptoms of inadvertent intravenous administration.

Disposal procedure

- After injection, engage the needle safety device by pressing the safety shield on a hard surface to cover and lock shield over the needle.

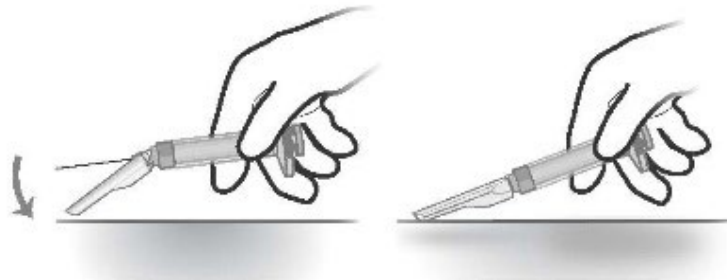

- Immediately discard used syringe and unused needle in an approved sharps container.
- Unused needle should not be saved for future use.

